

# AXXICON CHECK LIST FOR AIM INSERTS



[www.axxicon.com](http://www.axxicon.com)

Axxicon Quotation Number Q \_\_\_\_\_  
Revision Number \_\_\_\_\_

Company name \_\_\_\_\_  
Country \_\_\_\_\_  
Contact Person \_\_\_\_\_  
Email \_\_\_\_\_

Date \_\_\_\_\_  
Agent \_\_\_\_\_  
Contact Person \_\_\_\_\_  
Email \_\_\_\_\_

### STANDARD INSERT (see 5.3 up to 5.6 of AIM Information Booklet)

If yes, please specify:

### MODIFIED INSERT BASED ON A STANDARD INSERT (like different length or thickness etc.)

If yes, please specify required modifications:

### CUSTOMIZED INSERT

Please specify required modifications

### MOULD TEMPERATURE

- 10-140 (Low temperature - water / oil)
- 140-200 (High temperature - water / oil)

### MATERIALS

- Material: \_\_\_\_\_
- Fillers: \_\_\_\_\_
- Shrink factor  0 - 1%  
 Other \_\_\_\_\_

### TEXTURE \*

- No
- Yes:  
If yes: Please specify  
\_\_\_\_\_

### LOGO \*

- No
- Yes  
If yes: Add logo  
\_\_\_\_\_

### COATING \*

- None
- Tin coating
- MCP coating

### CHAIN HOLE \*

- No
- Yes

### CAVITY SPECIFICATIONS \*

- Cavity number engraved  Yes  No
- Polishing quality  N1  N2

### NOTCHES \*

- No
- Yes:  
 \_\_\_\_\_

### RUNNER SWITCH \*

- No
- Yes  
 \_\_\_ way valve

### CUSTOM SKETCH

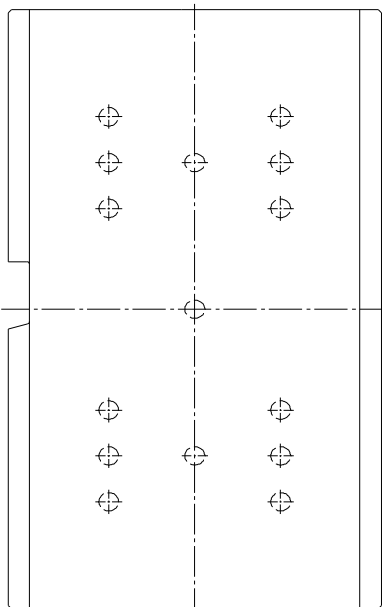

### CAVITY SPECIFICATIONS \*

- Roughness measurement  Yes  No
- Cavity measurement  Yes  No

*\* For add on prices, please refer to price list*

### NOTE

All AIM parts will be tested with a material selected by Axxicon  
Standard material PP or PE

### REMARKS

\_\_\_\_\_  
\_\_\_\_\_  
\_\_\_\_\_

**Please return this data sheet to your local agent or to: [a.lavrijsen@axxicon.com](mailto:a.lavrijsen@axxicon.com)**